

atrium

MONTREUX

BAT. 3
LOT 36

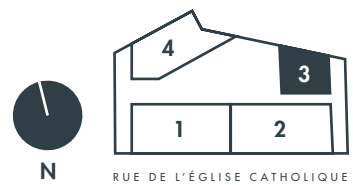
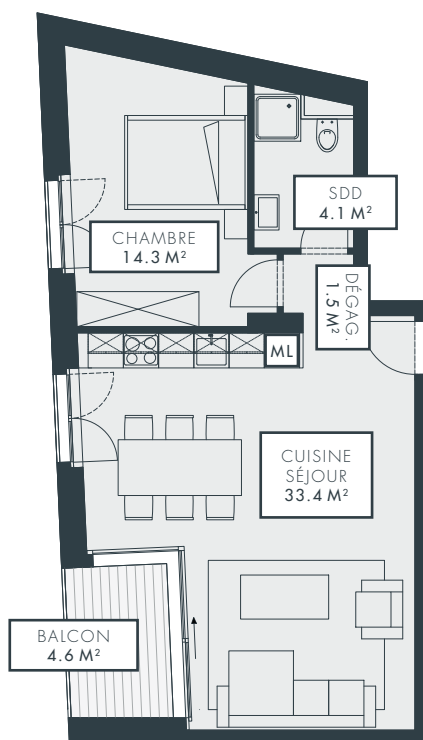

BÂTIMENT 3

NIVEAU	2 ^{ÈME}	SURFACE HABITABLE	54.1 m ²
ORIENTATION	○	BALCON	4.6 m ²
NBRE DE PIÈCES	2.5	SURFACE DE VENTE	56.4 m ²

atrium-montreux.ch